

Rushcutters Bay

60m

310m nearest access to water's edge

6m

harbour stairs

wider pedestrian promenade

additional seating

additional seating

turfied northern lawn

NEW BEACH RD

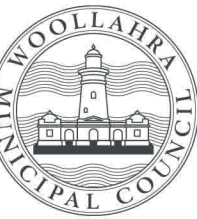



# Landscape Plan

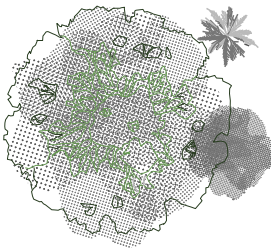

Existing Tree

Water



Lawn



## Mass planting

Existing asphalt



Reinforced concrete with honed finish and exposed aggregate (TBC)

Reinforced concrete with heavy shotblast finish



Reinforced concrete footpath with broomed finish



## Seats



### Feature seating

Existing lights poles

Proposed lights poles

Safety notice Sign to be further detailed

Sea stair with centrally placed handrail  
& tactiles (top of stair)



## Extent of works

+ 1.54    + -0.81    Spot levels

+ TOW 2.25

- A Existing Ficus Hillii along New Beach Road
- B Existing bollards to be retained
- C New sea stair with central handrail provides access to water
- D Widened promenade to form plaza area around sea stair with seating opportunity
- E Northern Plaza - widened promenade to form plaza area with seats
- F Widened planter to property boundary
- G Extended concrete path at interface with surrounding footpath
- H Mass planting pocket to sea stair plaza area

